



EXPERIENCE AND QUALITY  
HARVESTING OF FRUIT AND OLIVE TREES





The **Magnum** multi-purpose vehicle was designed to perform all the **tasks** necessary for the **harvesting of olive and fruit trees**, ensuring the profitability of the farm.

It is noteworthy for its great **agility and manoeuvrability** in the field, thanks to a high-performance and reliable hydraulic circuit based on the experience gained by Moresil.

**VEHICLE APPROVED FOR USE ON ROADS**

**GREAT MANOEUVRABILITY, MAXIMUM PERFORMANCE**



It includes a state-of-the-art **Deutz 120 CV** motor which, combined with the electronic content of the pump provides a **low fuel consumption and gas emission**.

The MAGNUM Buggy adapts to any type of land, thanks to its hydrostatic transmission with **full four-wheel drive system** and independent pump for each axis, conferring it **fastness and manoeuvrability**.

We use top brand **hydraulic material such as** Sauer Danfoss, Poclain, Perker, etc.

The design of **the control station** provides the driver **high visibility** of the work area and an easy use as it provides a steering **wheel and a single pedal**.

It has a **telescopic boom** with quick connect coupling systems to facilitate the change of the different accessories available.

The chassis of the Magnum multi-purpose vehicle **is manufactured with high-strength steel**.



More information and videos



Its electronic **control unit** displays essential information of the motor and the machine's different systems. Possibility of **programming** several **vibration** programmes for the different type of trees.

**Electronically-controlled Diesel motor** that automatically adapts to the movement or vibration requirements, **improving the consumption of fuel**.

**The latest generation technology of the motor** ensures that a particulate and urea filter is not required.



## THE UNION BETWEEN POWER AND EFFICIENCY

SIZES AND WEIGHTS		MOTOR	
L x Wd x H (m)	3.60 x 2.05 x 1.91 m	Common Rail injection system	
Road width	1.65 m	Power KW/CV	90/120
Dist. between axes	1.92 m	Cubic capacity	3600 cc
Weight	2600 Kg	TANKS	
HYDROSTATIC TRANSMISSION		Fuel	80 L
2 drive wheels in front axis		Hydraulic	120 L
2 drive wheels in back axis		TELESCOPIC ARM	
Max. speed	15Km/h	Elevation	4.30 m
		Extension	1.30 m

The **electronic system** is highly simplified due to the use of the data transmission **BUS CAN technology**, which **increases the work performance**.

Thanks to the **joystick**, a comfortable handling is achieved with which all the **movements are controlled very gently**.

## ACCESSORIES

Thanks to its **ability to easily exchange the implements**, it is possible to change from demolition works to other tasks with a simple operation, since it is provided with a fast coupling system.



### TREATMENT TANK

Capacity for 800 litres.  
Manufactured in one single piece and with high chemical resistance.  
Spraying width of approx. 4 m.



### BRUSHCUTTER DB-240

Approx. work width 2.5 m.  
High-power hydraulic group with double spindle and terrain copier roller.

## MULTI-PURPOSE VEHICLE GREATER PROFITABILITY



### COLLECTION HOPPER

Collection width: 1.90 m  
Capacity: 0.5 m<sup>3</sup>

# VIBRATING HEADS

We manufacture vibrators **easy to install** both on our vehicles and on different tractor loaders models, mini skidsteer loaders and other kind of vehicles.

They are designed to perform **a high-frequency orbital vibration, with instant start and stop.**

It enables **vibrating in both directions**, achieving **high demolition percentages** without damaging the trees.

It also provides **a clamp tightening system** that does not damage the bark of the tree in adverse conditions.



More information and videos

## CENTRAL VIBRATION MOTOR DOUBLE CLAMP CYLINDER



### MV200

Max. clamp opening:  
400 mm.  
Recommended trunk diameter:  
up to 200 mm.

\*Adaptable to Cima 500 Turbo



### MV350

Max. clamp opening:  
500 mm.  
Recommended trunk diameter:  
up to 350 mm.



### MV500

Maximum clamp opening:  
700 mm.  
Recommended trunk diameter:  
up to 500 mm.

## STUDS

Of different hardness for  
the different tree  
conditions



## SKIRT AND FELT

Variety of skirts and felts



# ARMS FOR TRACTORS

Our models are adaptable to **any type of front loader** available on the market. We provide two models, both telescopic and articulated.



## ARTICULATED ARM

The pantographic arm stands out for **its great mobility and its gentle and precise movements**. Its advantages are a perfect visibility of the tree trunks from the position on the tractor.

The pantographic arm fits on the front loader of the tractor and from its closest position it extends 1.5 m.

This arm is ideal for **multi-trunk** plantations or with limited space for manoeuvring, thanks to its 3 turning axes in addition to the extension.



## TELESCOPIC ARM

It is handled with a **joystick** which controls all the vibrator's functions and the **telescopic arm**. It extends to up to 500 mm and turns 30°. It is **easy to handle and manoeuvre**.



## HYDRAULIC STATION

Tank capacity of 350 litres, which compensates the front weight and prevents the oil from heating. It has a heat exchanger and is independent from the tractor. It enables the back coupling of the tow

# COLLECTOR PLATFORM

Fans available in different sizes according to the requirements of each plantation.

**Easily removable umbrella** to work only with the clamp, when the plantation does not enable umbrella.

Activation of all **the functions** both of the vibrator and umbrella with the **joystick** from the tractor cab.

FUNCTIONS
ARM
Turning
Lifting
Extension
CLAMP
Turning
Tightening
PLATFORM
Canvas opening/closing
Lifting/lowering rods
Opening/closing flap



The umbrella has a **mechanism that enables us placing it low** to help the olive dropping in varieties that need it. It also provides **retractile rods** that facilitate this manoeuvre even more.



# OLIVE SWEEPING MACHINE

Water-cooled 4 cylinder Diesel motor. Four-wheel **hydrostatic transmission**. collection brushes manufactured with a special component that confers them **high durability and flexibility**.

## Independent steering wheel and controls



Our olive sweepers are designed to collect the olives from the floor and then take them to the place required.

Its great manoeuvrability, thanks to its completely hydraulic system, and its small size, provide the olive collecting machine exceptional features for the collection on the ground, by means of a sweeping system, of the majority of existing olive trees.

MODEL	CV	TRANSMISSION	SWEEPING HOPPER	VIBRATOR
3700 PLUS	37	2 PUMPS	YES	NO
CIMA 500	51	2 PUMPS	YES	NO
CIMA 500 TURBO	63.9	2 PUMPS	YES	YES



Currently, and due to the new safety and occupational risk prevention rules, all the Moresil machine models are provided with a certified safety arch.

## HOPPER TECHNICAL FEATURES

Collection width: 1.90 m.  
Hopper capacity: 0.50m<sup>3</sup> approx.  
Maximum machine height: 1.10 m. approx.



More information and videos



Different fast exchangeable accessories to carry out all the tasks required in olive and fruit trees, ensuring the profitability.

## VEHICLE TECHNICAL FEATURES

Total length	2650 mm
Total height	1365/2110 mm
Total width	1530 mm
Lane width	1200 mm
Hopper capacity	0.5 m <sup>3</sup>
Sweeper working width	1900 mm
Maximum discharge height	2.10 m. aprox



TREATMENT TANK  
- Capacity 600 l.  
- Low pressure pump



BRUSHCUTTER  
- Working width: 1.65 m.  
- Hydraulic activation

## ACCESSORIES

# OLIVE CLEANERS

High performance and quality cleaning. exchangeable cleaning cylinders for the different olive sizes. This machine can provide a discharge system in tow or in bales

**ML- 4000**



**ML- 8000**

The Moresil olive cleaner is designed to clean the olives collected by the Moresil olive collecting machine, in the same place where the harvesting is taking place.

It activates with the power take-off of a very low power tractor at the same time that it is towed by it.

With the olive cleaning machine the swept olive is pre-cleaned eliminating the plant elements that may have been on the ground and all the aggregates of a size different to that of the olive collected.



**CERTIFIED**

## SIEVE

The sieve is used coupled to the tractor's blade and activates through its hydraulic connection. thanks to its small size it adapts to the majority of plantation frames and its optimum performance is achieved thanks to a sieves and fans system.

- Sieve frequency and inclination adjustment.
- High-resistant self produced fans.



## EASY TRANSPORT AND HANDLING

## FOLDABLE BRUSHCUTTER MODEL MP-3

This machine achieves maintaining vegetation cover, which is a technique framed within the no tillage practices and complementary to the contribution of plant residues to the surface of the soil to control the erosion.

Working width: 3.25m

Total width: 3.40 m.

Width when folded: 2.10 m.

Power: 80/90 HP

Maximum protection: clutches between groups



**HYDRAULIC FOLDING SYSTEM FOR ITS EASY TRANSPORT**



More information and videos

# MORESIL, AT THE SERVICE OF THE AGRICULTURE PROFESSIONALS



Moresil is a agriculture machinery production company with more than 60 years experience in this sector. It develops three well-differentiated product lines such as headers for harvesters, machinery for the collection of olives and fruits and cereal selector cleaners.

Its manufacturing quality is certified under ISO 9001 standard, as well as all its suppliers. It has modern facilities along with a qualified technical team, with the aim of producing machinery with the best

performance and always adapted to the continuous changes in agriculture.

As a result, it provides its clients with the technology adapted to the market's needs and requirements.



More information and videos

ISO 9001

**BUREAU VERITAS**  
Certification

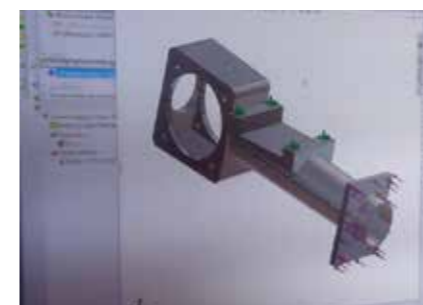

Engineering and design



Laser cutting



CNC machining lathes and Centres

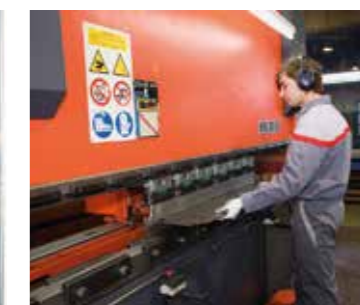

CNC folder



Welding robot



Powder paint installation



Assembly



- Qualified staff at the disposal of our clients.
- Immediate availability of spare parts.
- On-site maintenance and technical assistance.

Note: the features of our products are indicative. We reserve the right to modify without prior notice. The photographs of the machines may include an optional element.







MORESIL S.L.

 CTRA. CÓRDOBA - PALMA DEL RIO, km.31  
14730 POSADAS (CÓRDOBA) ESPAÑA

 TEL. (+34) 957 630 243

 FAX. (+34) 957 631 477

 [moresil@moresil.com](mailto:moresil@moresil.com)

[www.moresil.com](http://www.moresil.com)



GPS Coordinates  
(37.804656, -5.109318)

